

AEG-TELEFUNKEN

Lieferprogramm
Delivery Program

Bildverstärkerröhren
Image Intensifier Tubes

Infrarot-Bildwandler
Infrared Image Converter

EBSI-Kameraröhre
EBSI-Camera Tube



Typ <i>Type</i>	Betriebs- spannung <i>Operating voltage</i>	Verstärkung (ca.) <i>Gain (approx.)</i>	Mitten- auflösung <i>Resolution at Centre I_p/mm</i>	Abbildungs- Verhältnis <i>Magnification</i>	Photokathode · <i>Photocathode</i>		
					Durch- messer <i>Diameter</i> mm	Fenster- material <i>Window material</i>	Typ <i>Type</i>

Bildverstärkerröhren · *Image Intensifier Tubes*

2. Generation · *Inverter*

XX 1400	2,65 V	> 35 000	> 30	1 : 0,98	25	Fo ²⁾	S25
----------------	--------	----------	------	----------	----	------------------	-----

1. Generation

3stufig Fiberoptik gekoppelt · *3 stage fiberoptic coupled*

XX 1066	6,70 V	50 000	35	1 : 0,83	25	Fo ²⁾	S25
XX 1210	2,65 V	50 000	35	1 : 0,94	18	Fo ²⁾	S25
XX 1211	2,65 V	50 000	35	1 : 0,94	18	Fo ²⁾	S25

2stufig Fiberoptik gekoppelt · *2 stage fiberoptic coupled*

XX 1250	2 x 14 kV	4 000	45	1 : 0,95	18	Fo ²⁾	S25
XX 1277	2,65 V	8 000	60	1 : 0,36	18	Fo ²⁾	S25

1stufig · *1stage*

XX 1430	14 kV	100	60	1 : 0,95	40	Fo ²⁾	S25
XX 1190	14 kV	100	60	1 : 0,93	25	Fo ²⁾	S25
XX 1200	14 kV	100	60	1 : 0,93	18	Fo ²⁾	S25

Infrarot-Bildwandler · *Infrared Image Converter*

6914	16 kV	> 0,6 cd/lm ¹⁾	65	1 : 0,75	25	Gl ⁴⁾	S1
6929	12 kV	> 0,4 cd/lm ¹⁾	65	1 : 0,75	19	Gl ⁴⁾	S1
8598	16 kV	> 0,5 cd/lm ¹⁾	65	1 : 1,00	11	Gl ⁴⁾	S1

EBSI-Kameraröhre · *EBSI-Camera Tube* (Electron Bombarded Silicon Tube)

Typ <i>Type</i>	Röhren- gruppe <i>Tube Section</i>	Betriebs- spannung <i>Operating Voltage</i>	Signalstrom bei <i>Signal current at 1 mlx</i>	Mittenauf- lösung (ca.) <i>Resolution at Centre (approx.)</i>	Photokathode · <i>Photocathode</i>		
					Bildeingang <i>Image Input</i>	Fenster- material <i>Window material</i>	Typ <i>Type</i>
XQ 1340	Intensifier ⁵⁾ Section	- 5... - 12 kV	ca. 100 nA	600 FS-Zeilen TV-Lines	12 x 16 mm ²	Fo ²⁾	S25
	Scanning ⁶⁾ Section	Standard Vidicon operation			9,6 x 12,8 mm ²		

¹⁾ Konversions-Koeffizient, Infrarot gefiltert
Conversion Coefficient, Infrared filtered

²⁾ Faserglas
Fiberoptic

³⁾ Faserglas mit Schutzscheibe
Fiberoptic with glass cover plate

⁴⁾ Glas
Glass

⁵⁾ Diode: Fokussierung-elektrostatisch
Focusing-electrostatic

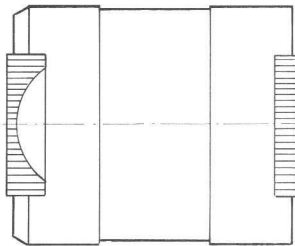

XX 1400

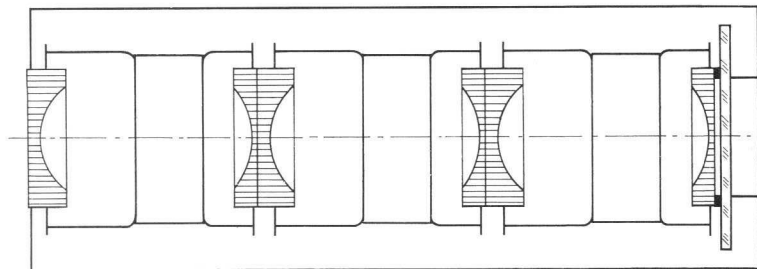

XX 1066

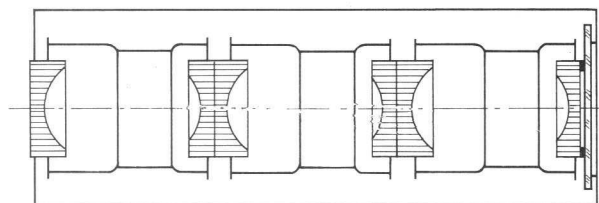

XX 1210 · XX 1211

Schirm · Screen			Röhren-Abmessungen · Tube dimensions			Röhre vergossen Tube potted
Durchmesser Diameter mm	Fenstermaterial Window material	Typ Type	Länge Length mm	Durchmesser Diameter mm	Gewicht (ca.) Weight (approx.) g	

25	Fo ²⁾	P20	77	63	350	X
----	------------------	-----	----	----	-----	---

25	Fo+ ³⁾	P20	196	70	800	X
18	Fo+ ³⁾	P20	148	53	720	X
18	Fo+ ³⁾	P20	148	53	750	X

18	Fo ²⁾	P20	98	50	360	—
7	Fo+ ³⁾	P20	108	57	300	X

40	Fo ²⁾	P20	94	90	500	—
25	Fo ²⁾	P20	62	60	200	—
18	Fo ²⁾	P20	49	45	180	—

25	Gl ⁴⁾	P20	74	48	170	—
19	Gl ⁴⁾	P20	58	34	160	—
11	Gl ⁴⁾	P20	42	30	140	—

Röhrenabmessungen · Tube Dimensions		
Länge Length mm	Durchmesser Diameter	Gewicht (ca.) Weight (approx.) g
188	48	200

⁶⁾ Vidicon: Fokussierung-elektromagnetisch
Focusing-electromagnetic
Ablenkung-elektromagnetisch
Deflection-electromagnetic

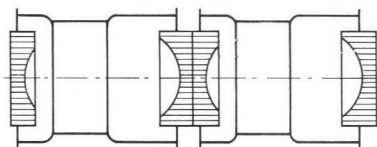

XX 1250

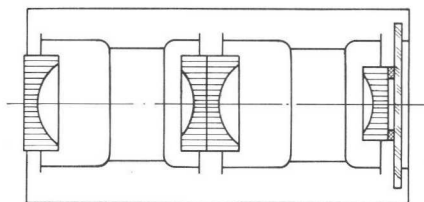

XX 1277

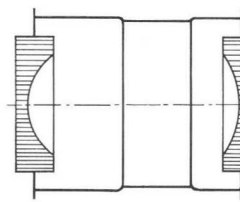

**XX 1430
XX 1190**

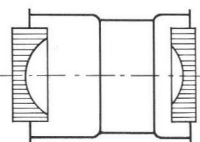

XX 1200

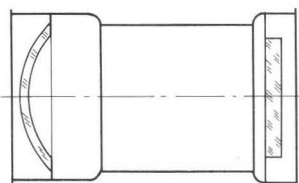

6914

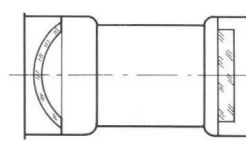

6929

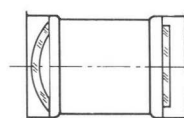

8598

Integrierter Spannungs-Wandl. <i>Integrated Power supply</i>	Automatische Helligk.-Steuerung <i>Automatic Brightness Contr.</i>	Externe Verst.-Steuerung <i>External Gain Control</i>	Spitzenlicht- selbstbegrenzung <i>Point-Highlight Control</i>	Blitz- geschützt <i>Flash protected</i>
--	--	---	---	---

X	X	X	X	—
---	---	---	---	---

X	X	—	—	—
X	X	—	—	—
X	X	—	—	X

—	—	—	—	—
X	X	—	—	X

—	—	—	—	—
—	—	—	—	—
—	—	—	—	—

—	—	—	—	—
—	—	—	—	—
—	—	—	—	—

—	—	—	—	—
---	---	---	---	---

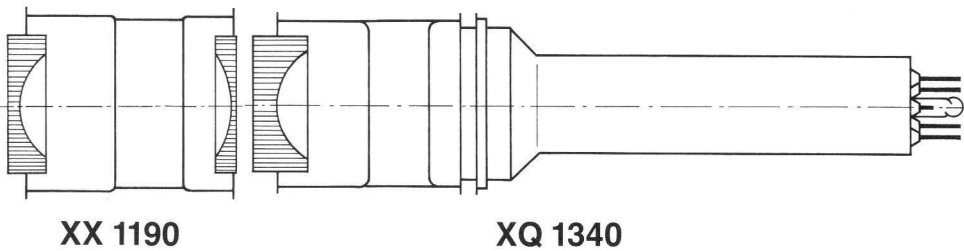

XX 1190

XQ 1340

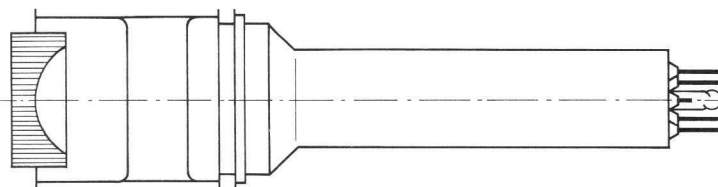

XQ 1340

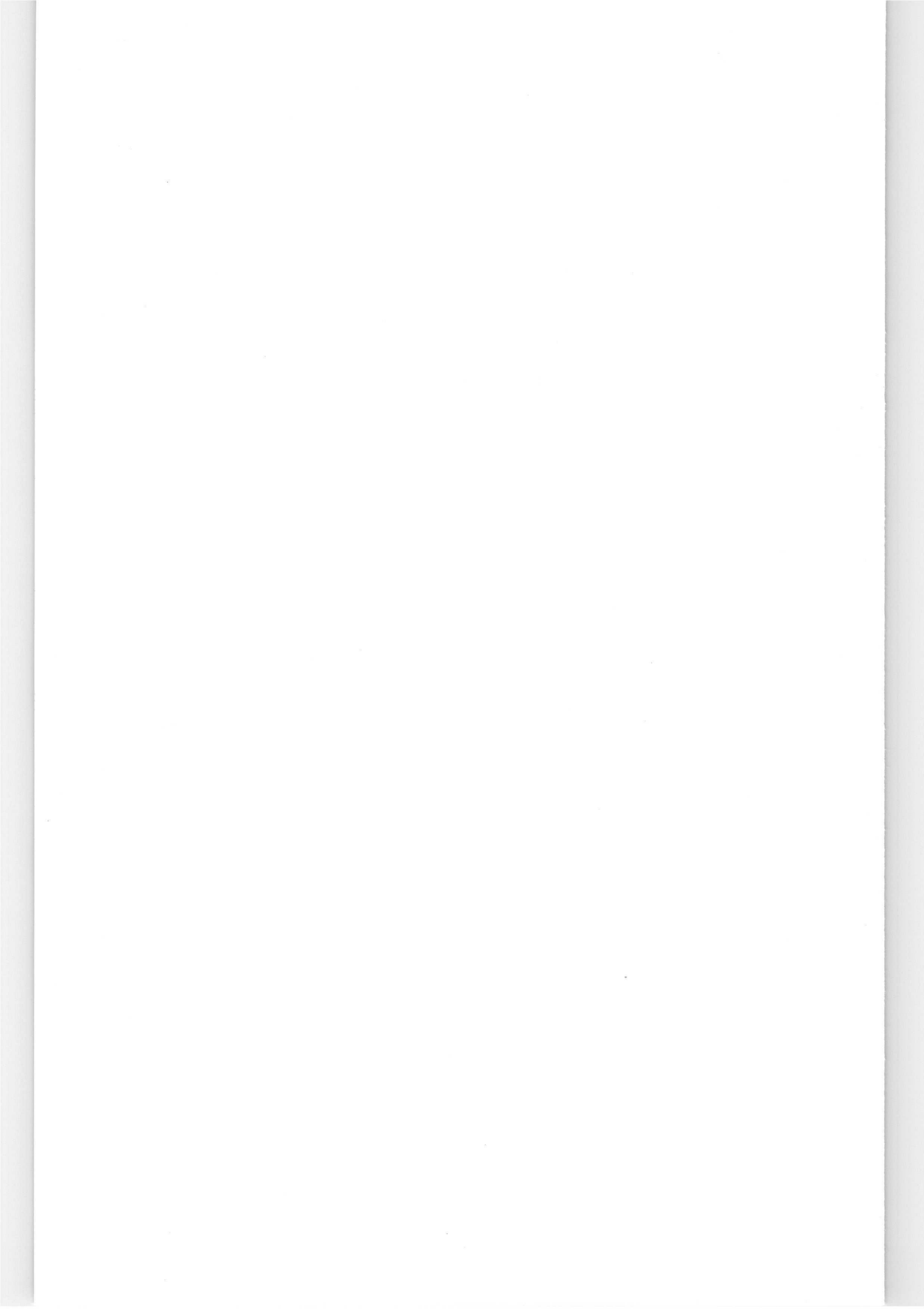

AEG-TELEFUNKEN
Serienprodukte
Geschäftsbereich
Elektronische Bauelemente
Fachbereich Technische Röhre
Söflingerstraße 100
D-7900 Ulm

AEG



AEG-Telefunken (U.K.) Ltd.,
Electronic Component Division,
217, Bath Road,
Slough, Berkshire, SL1 4AW.
Tel: Slough 872101
Telex: 847541